

RH-Q47A0-R/L

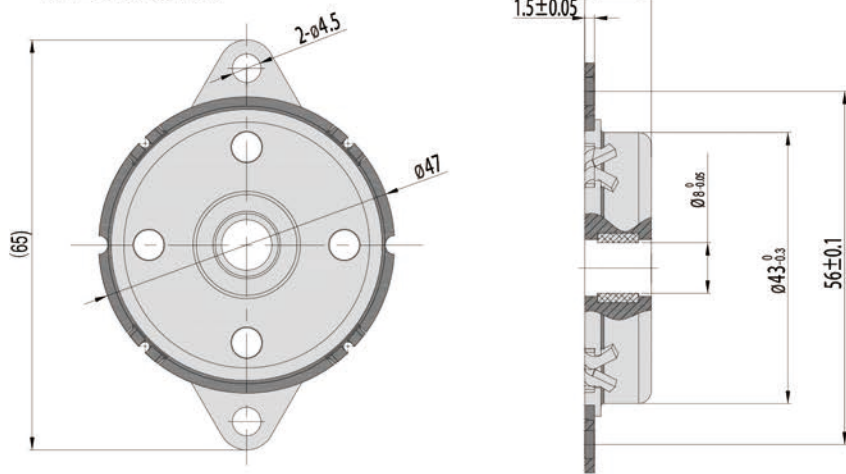

RH-Q47A0-B

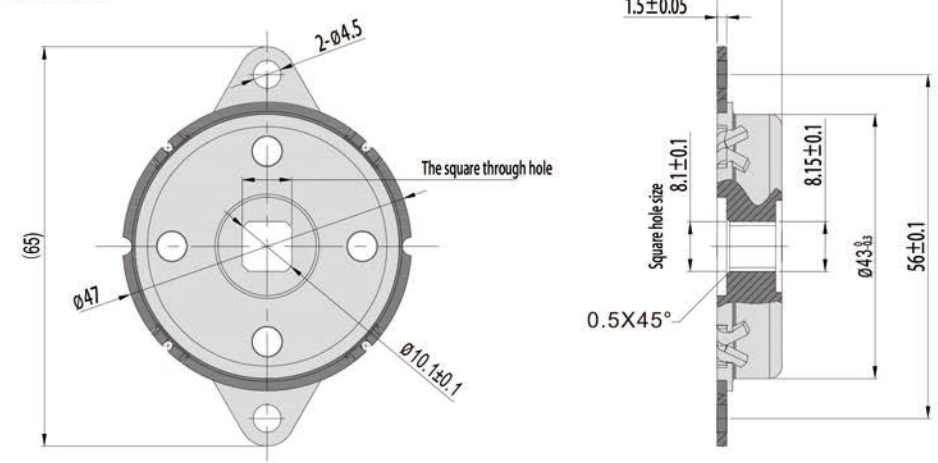

Model	Torque at 23°C and 20 rpm.	Damping direction
RH-Q47A0-B103	1.0±0.2N·m 10±2 kgf·cm	Bi-directional
RH-Q47A0-R103		Clockwise
RH-Q47A0-L103		Anticlockwise
RH-Q47A0-B153	1.5±0.3N·m 15±3 kgf·cm	Bi-directional
RH-Q47A0-R153		Clockwise
RH-Q47A0-L153		Anticlockwise
RH-Q47A0-B203	2.0±0.4N·m 20±4 kgf·cm	Bi-directional
RH-Q47A0-R203		Clockwise
RH-Q47A0-L203		Anticlockwise
RH-Q47A0-B253	2.5±0.5N·m 25±5 kgf·cm	Bi-directional
RH-Q47A0-R253		Clockwise
RH-Q47A0-L253		Anticlockwise

Recommended axle diameter	
Surface hardness	Above HRC55
Quenching depth	Above 0.5mm
Surface roughness	Under 1.0Z
Chamfer end	

FIDO  Motion Control

RH-Q47

Damper drawing