

RH-Q57A0

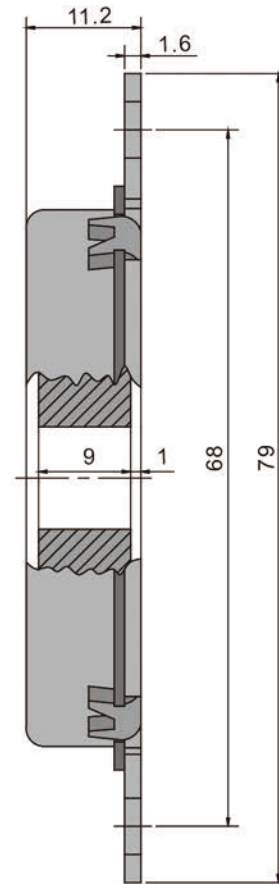
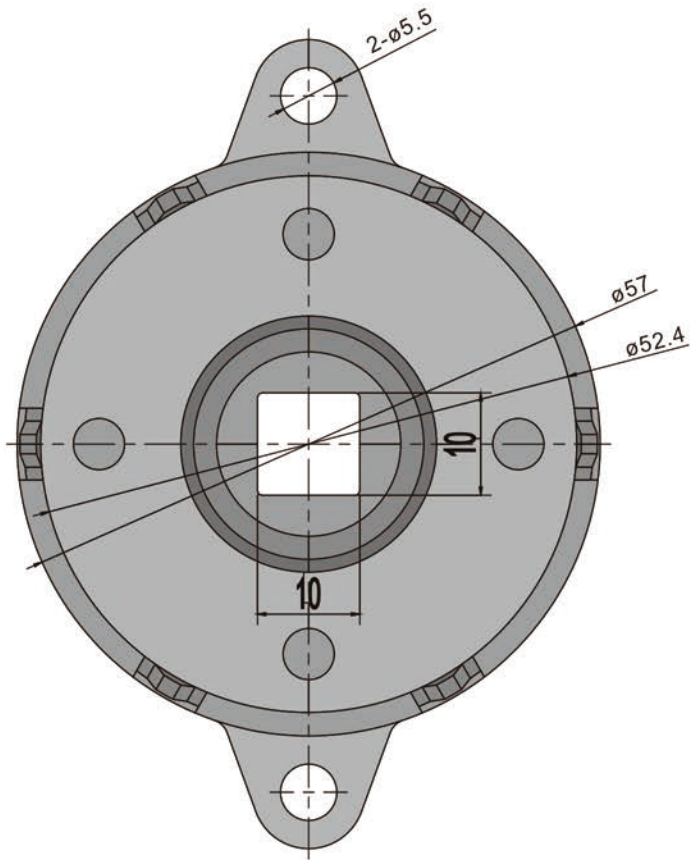

Model	Torque at 23°C and 20 rpm.	Damping direction
RH-Q57A0-B303	3.0±0.6N·m 30±6 kgf·cm	Bi-directional
RH-Q57A0-R303		Clockwise
RH-Q57A0-L303		Anticlockwise
RH-Q57A0-B403	4.0±0.8N·m 40±8 kgf·cm	Bi-directional
RH-Q57A0-R403		Clockwise
RH-Q57A0-L403		Anticlockwise
RH-Q57A0-B503	5.0±1.0N·m 50±10 kgf·cm	Bi-directional
RH-Q57A0-R503		Clockwise
RH-Q57A0-L503		Anticlockwise

Recommended axle diameter	
Surface hardness	Above HRC55
Quenching depth	Above 0.5mm
Surface roughness	Under 1.0Z
Chamfer end	

FIDO  Motion Control

RH-Q57

Damper drawing